



## 联系我们 / Contact Us

苏州为山之环境技术有限公司

Suzhou Weishans Climate Technologies Co.,Ltd

公司官网 / Web:www.weishans.com

地址：江苏省苏州市相城区黄埭镇咏春科技园

Address: Yongchun Science and Technology Park, Huangdai Town, Xiangcheng District, Suzhou City, Jiangsu Province

### 免责声明

技术数据在印刷前已经校对过，印刷之后有再更新的可能。如有对某一参数确认的需求，请联系苏州为山之环境技术有限公司。为山之对参数中可能存在的差错概不承担任何责任，为山之保留自行改变其产品而不预先通知的权利。

### Disclaimer

Our technical data have been checked before printing, but it is possible for data to be updated after printing. If you need to confirm a certain parameter, please contact Suzhou Weishans Climate Technology Co., Ltd. Weishans will not take any responsibilities for any possible errors in the parameters and reserve the right to change its products without prior notice.

Rev:202604

# WR系列

## 空调冷水机应用涡旋压缩机

Scroll Compressor for Air conditioning & Chiller Application

# R290

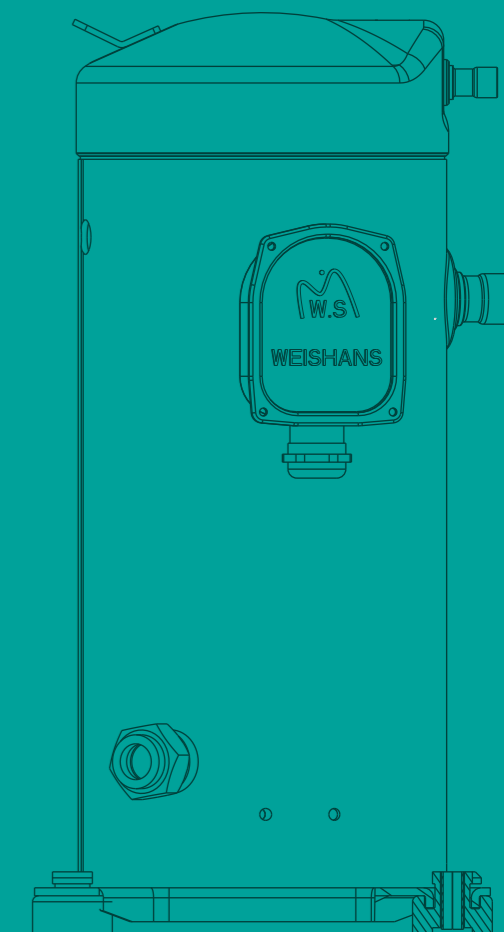

# 目录Catalog

公司简介 <i>About us</i>	02
命名规则 <i>Nomenclature</i>	03
应用范围 <i>Application Range</i>	04
技术参数 <i>Specification</i>	05
制冷量 <i>Cooling Capacity</i>	07
外形尺寸 <i>Dimensional Information</i>	13

## 苏州为山环境技术有限公司

成立于2018年6月，专注于开发节能环保型压缩机，是一家创新型科技企业。为山之研发的涡旋式热泵压缩机核心技术已取得重大突破，并成功应用于多个领域，包括但不限于工业制冷、商用热水、工业蒸汽、农业烘干、制冷工程、精密空调、轨道交通制冷、转轮除湿及工业余热回收等。公司拥有先进的自动化生产线和高精度检测与加工设备，创新工艺流程，产品覆盖从2匹至25匹。公司产品通过了CCC、CE、CB、ROHS & REACH和ISO 9001等多项国际认证。

公司高度重视知识产权保护，产品已获得多项专利证书，公司荣获江苏省民营科技企业和国家级高新技术企业称号。

展望未来，公司将继续加大研发投入，致力于为客户提供绿色环保的热泵及冷冻压缩机解决方案，以减少全球碳排放为使命，为构建绿色地球家园贡献力量。

## Suzhou Weishans Climate Technology Co., Ltd

was established in June 2018, and focuses on the development of energy-saving and environment protection compressors. It is an innovative technology enterprise. The core technology of the scroll heat pump compressors developed by Weishans has made significant breakthroughs and has been successfully applied in multiple fields, including but not limited to industrial refrigeration, commercial hot water, industrial steam, agricultural drying, refrigeration engineering, precision air conditioning, rail transit refrigeration, rotary wheel dehumidification and industrial waste heat recovery, etc.

The company owns advanced automated production lines and high-precision testing and machining equipments, innovated technological process, with products covering the range from 2HP to 25HP. The company's products have passed multiple international certifications including CCC, CE, CB, ROHS & REACH and ISO 9001.

The company attaches great importance to the protection of intellectual property rights and has obtained several patent certificates. The company has been awarded the titles of Jiangsu Private Technology Enterprise and National High-tech Enterprise.

Looking forward to the future, the company will continue to increase investment in research and development, and is committed to providing customers with green and environmentally heat pump and refrigeration compressor solutions. With the mission of reducing global carbon emissions, it will contribute to building a green Earth home.

Build a Nine-ren Mountain  
Forge Ahead  
为山九仞 砥砺前行

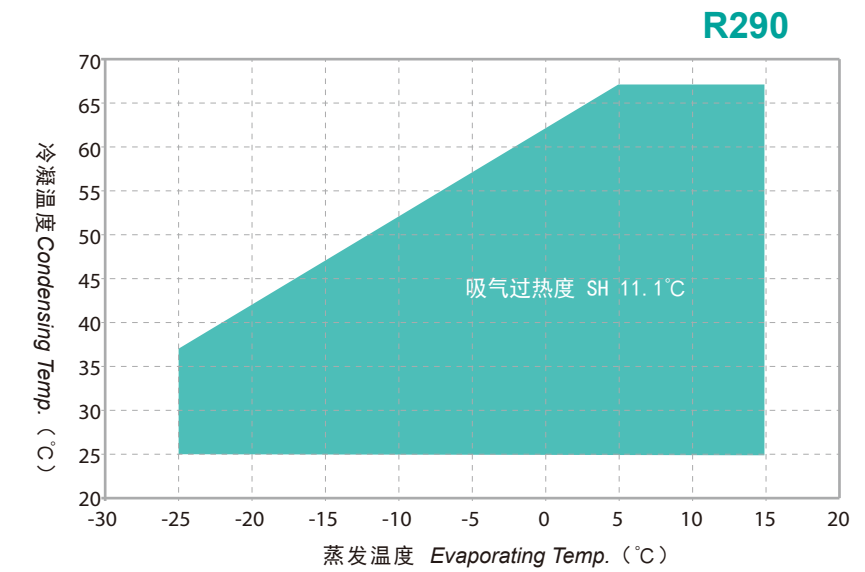
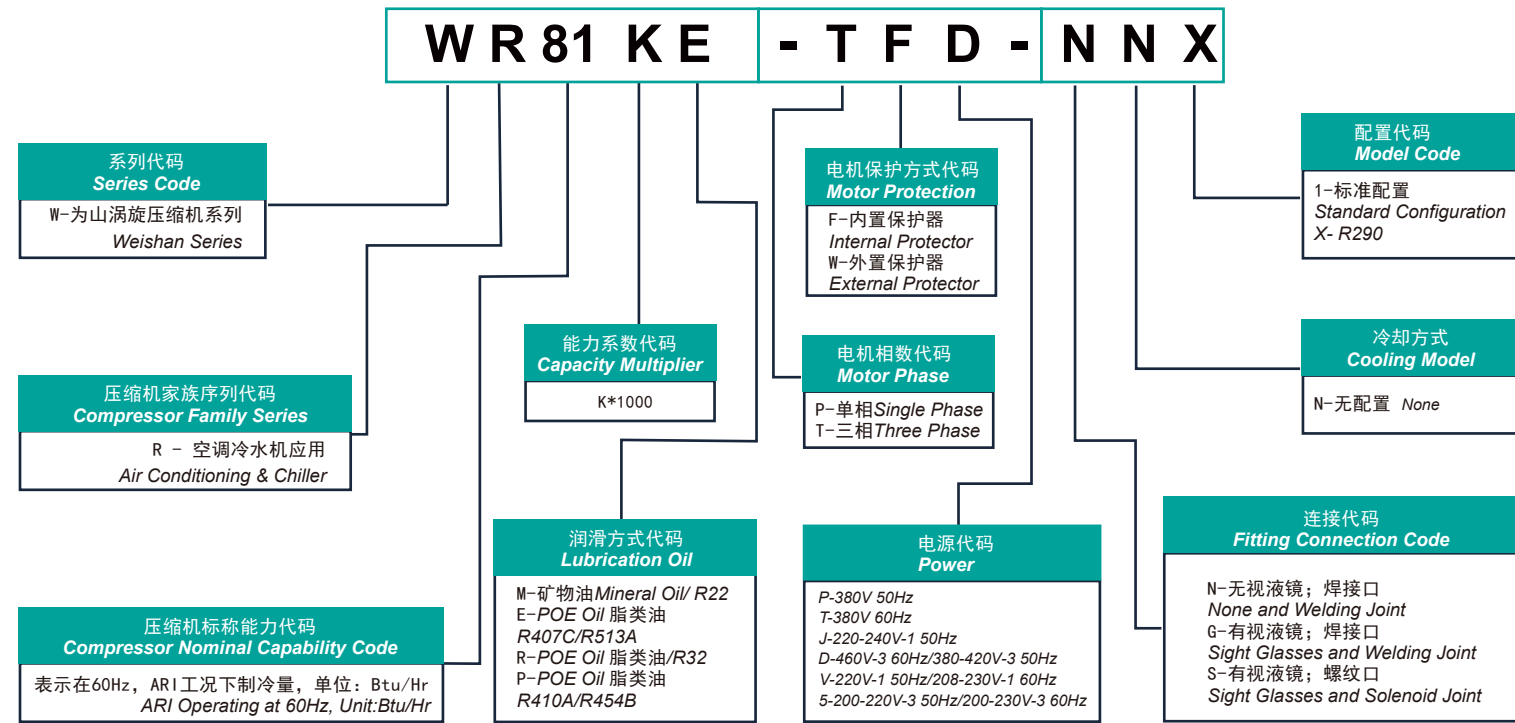

型号 Model	WR24KE-TFD-NNX	WR36KE-TFD-NNX	WR48KE-TFD-NNX	WR61KE-TFD-NNX	WR72KE-TFD-NNX	WR81KE-TFD-NNX	WR94KE-TFD-NNX
电制 Motor Power	380-420V/3~/50Hz or 460V/3~/60Hz						
名义功率 Nominal Power (HP)	2	3	4	5	6	7	8
排量 Displacement (cc/Rev)	32.3	50.6	63.9	84.5	98.9	108	127
制冷剂 Refrigerant	R290						
名义制冷量 Nominal Capacity (W)	5005	7858	9945	13338	15789	17085	20596
名义输入功率 Nominal Power (W)	1503	2346	2881	3762	4529	4895	5916
名义工况能效比 COP (W/W)	3.33	3.35	3.45	3.55	3.49	3.49	3.48
名义工况电流 Nominal Operating Current (A)	2.7	4.1	6.0	6.7	8.0	8.7	10.5
堵转电流 LRA (A)	38.8	38.8	38.8	59.3	83.6	83.6	117
最大运行电流 MOC (A)	5.2	7.1	8.9	11.8	13.8	15.0	17.7
曲轴箱加热器功率 Crankcase Heater (W)	70	70	70	70	70	70	90
接管尺寸 Fitting ID Size (mm)	排气管 Dis. Tube	12.94-13.10			12.94-13.10		22.37-22.51
	吸气管 Suc. Tube	22.37-22.51			22.37-22.51		34.97-35.10
外形尺寸 Dimension (mm)	长(L)	244.8			257.01		283.04
	宽(W)	230.5			230.5		240.5
	高(H)	402.55			442.7		522.7
底脚安装尺寸 Mounting Dim.(Dia.) (mm)	190.5x190.5						
润滑油类型 Lubrication Oil	POE						
润滑油初次充注量 Lubrication Oil Initial Charge (L)	1.4	1.4	1.4	1.8	1.8	1.8	3.0
润滑油重新充注量 Lubrication Oil Recharge (L)	1.2	1.2	1.2	1.6	1.6	1.6	2.8
最大工作压力 Maxium Operating Pressure (MPa)	高压侧 High Pressure Side	3.0					
	低压侧 Low Pressure Side	2.0					
重量 Weight (kg)	28	28	28	31	38	38	66

注: 蒸发温度7.2°C, 冷凝温度54.4°C, 回气温度18.3°C, 过冷度8.3°C  
Note: Evaporating Temperature 7.2°C, Condensing Temperature 54.4°C, Return Gas Temperature 18.3°C, Subcooling 8.3°C.

型号 Model	WR108KE-TFD-NNX	WR125KE-TFD-NNX	WR144KE-TFD-NNX	WR160KE-TFD-NNX	WR190KE-TFD-NNX	WR250KE-TWD-GNX	WR310KE-TWD-GNX
电制 Motor Power	380-420V/3~/50Hz or 460V/3~/60Hz						
名义功率 Nominal Power (HP)	9	10	12	13	15	20	25
排量 Displacement (cc/Rev)	143.1	167.2	190.8	209	248.9	325	400
制冷剂 Refrigerant	R290						
名义制冷量 Nominal Capacity (W)	22915	26694	30786	33728	40212	52506	64623
名义输入功率 Nominal Power (W)	6557	7713	8561	9267	11177	14594	17962
名义工况能效比 COP (W/W)	3.49	3.46	3.60	3.64	3.60	3.60	3.60
名义工况电流 Nominal Operating Current (A)	11.6	13.6	15.1	16.4	19.8	25.8	31.7
堵转电流 LRA (A)	117	117	117	117	117	267.9	304
最大运行电流 MOC (A)	19.9	23.3	26.6	29.1	34.7	45.3	55.7
曲轴箱加热器功率 Crankcase Heater (W)	90	90	90	90	90	90	90
接管尺寸 Fitting ID Size (mm)	排气管 Dis. Tube	22.37-22.51				28.81-28.95	
	吸气管 Suc. Tube	34.97-35.10				34.97-35.10	
外形尺寸 Dimension (mm)	长(L)	283.04		283.04		296.05	
	宽(W)	240.5		235.5		286.05	
	高(H)	522.7		522.7		653.7	
底脚安装尺寸 Mounting Dim.(Dia.) (mm)	190.5x190.5						
润滑油类型 Lubrication Oil	POE						
润滑油初次充注量 Lubrication Oil Initial Charge (L)	3.0	3.0	3.2	3.2	3.2	5.0	5.0
润滑油重新充注量 Lubrication Oil Recharge (L)	2.8	2.8	3.0	3.0	3.0	4.8	4.8
最大工作压力 Maxium Operating Pressure (MPa)	高压侧 High Pressure Side	3.0					
	低压侧 Low Pressure Side	2.0					
重量 Weight (kg)	66	66	66	66	66	92	92

注: 蒸发温度7.2°C, 冷凝温度54.4°C, 回气温度18.3°C, 过冷度8.3°C  
Note: Evaporating Temperature 7.2°C, Condensing Temperature 54.4°C, Return Gas Temperature 18.3°C, Subcooling 8.3°C.

型号Model	项目Item (kW)	Tc\Te	-25°C	-20°C	-15°C	-10°C	-5°C	0°C	5°C	10°C	15°C	
WR24KE-TFD-NNX	Q	65°C							4.06	4.8	5.65	
	P							1.84	1.84	1.84		
	Q	60°C						3.66	4.35	5.13	6.02	
	P							1.67	1.67	1.67	1.67	
	Q	55°C						3.27	3.9	4.62	5.44	6.38
	P							1.51	1.52	1.52	1.52	
	Q	50°C					2.9	3.47	4.13	4.89	5.75	6.73
	P						1.37	1.37	1.38	1.38	1.38	1.38
	Q	45°C			2.55	3.07	3.67	4.36	5.15	6.05	7.07	
	P				1.24	1.24	1.25	1.25	1.25	1.25	1.25	1.25
	Q	40°C		2.22	2.69	3.23	3.86	4.58	5.41	6.35	7.4	
	P			1.12	1.12	1.13	1.13	1.13	1.14	1.14	1.14	1.14
Q	35°C	1.91	2.33	2.82	3.39	4.05	4.8	5.66	6.63	7.73		
P			1.01	1.01	1.01	1.02	1.02	1.03	1.03	1.03	1.03	
Q	30°C	2.01	2.45	2.96	3.55	4.23	5.02	5.91	6.92	8.05		
P			0.91	0.91	0.92	0.92	0.92	0.93	0.93	0.93	0.94	
Q	25°C	2.11	2.57	3.1	3.71	4.42	5.23	6.15	7.19	8.37		
P			0.82	0.82	0.82	0.83	0.83	0.84	0.84	0.84	0.85	
WR36KE-TFD-NNX	Q	65°C							6.38	7.54	8.87	
	P							2.87	2.88	2.88		
	Q	60°C						5.75	6.82	8.05	9.45	
	P							2.61	2.61	2.61	2.61	
	Q	55°C						5.14	6.13	7.26	8.55	10.01
	P							2.36	2.37	2.37	2.37	2.37
	Q	50°C					4.56	5.46	6.49	7.68	9.03	10.56
	P						2.14	2.14	2.15	2.15	2.16	2.15
	Q	45°C			4	4.82	5.76	6.85	8.09	9.5	11.1	
	P				1.93	1.94	1.95	1.95	1.95	1.96	1.95	1.95
	Q	40°C	3.48	4.22	5.08	6.06	7.2	8.49	9.96	11.62		
	P			1.74	1.75	1.76	1.76	1.77	1.77	1.77	1.77	1.77
Q	35°C	3	3.66	4.44	5.33	6.36	7.54	8.89	10.41	12.14		
P			1.57	1.58	1.58	1.59	1.6	1.6	1.61	1.61	1.61	
Q	30°C	3.16	3.85	4.65	5.58	6.65	7.88	9.27	10.86	12.64		
P			1.42	1.42	1.43	1.44	1.44	1.45	1.45	1.46	1.46	
Q	25°C	3.32	4.03	4.86	5.82	6.93	8.21	9.66	11.29	13.14		
P			1.28	1.28	1.29	1.29	1.3	1.3	1.31	1.32	1.32	
WR48KE-TFD-NNX	Q	65°C							8.07	9.55	11.23	
	P							3.53	3.53	3.53		
	Q	60°C						7.28	8.64	10.19	11.96	
	P							3.2	3.21	3.21	3.21	
	Q	55°C						6.51	7.75	9.18	10.82	12.67
	P							2.9	2.91	2.91	2.91	2.91
	Q	50°C					5.77	6.9	8.22	9.72	11.43	13.37
	P						2.62	2.63	2.64	2.64	2.65	2.64
	Q	45°C			5.06	6.1	7.29	8.67	10.24	12.03	14.05	
	P				2.37	2.38	2.39	2.39	2.4	2.4	2.4	2.4
	Q	40°C	4.4	5.34	6.42	7.67	9.11	10.75	12.61	14.71		
	P			2.14	2.15	2.16	2.16	2.17	2.18	2.18	2.18	2.18
Q	35°C	3.8	4.64	5.61	6.74	8.05	9.54	11.25	13.18	15.36		
P			1.93	1.94	1.94	1.95	1.96	1.97	1.97	1.97	1.98	
Q	30°C	4	4.87	5.88	7.06	8.41	9.97	11.74	13.74	16		
P			1.74	1.75	1.76	1.76	1.77	1.78	1.78	1.79	1.79	
Q	25°C	4.2	5.1	6.15	7.37	8.78	10.39	12.22	14.3	16.63		
P			1.57	1.57	1.58	1.59	1.59	1.6	1.61	1.62	1.62	

注：以上数据基于 11.1K 吸气过热度，8.3K 过冷度  
Note: The above data are based on 11.1k supheating and 8.3k subcooling.

型号Model	项目Item (kW)	Tc\Te	-25°C	-20°C	-15°C	-10°C	-5°C	0°C	5°C	10°C	15°C	
WR61KE-TFD-NNX	Q	65°C							10.83	12.8	15.06	
	P							4.61	4.61	4.61		
	Q	60°C						9.76	11.58	13.67	16.04	
	P							4.18	4.19	4.19	4.19	
	Q	55°C						8.73	10.4	12.32	14.51	17
	P							3.79	3.8	3.8	3.81	3.8
	Q	50°C					7.73	9.26	11.02	13.03	15.33	17.93
	P						3.42	3.44	3.45	3.45	3.46	3.45
	Q	45°C			6.79	8.18	9.78	11.62	13.73	16.13	18.84	
	P					3.09	3.11	3.12	3.13	3.13	3.14	3.13
	Q	40°C		5.91	7.16	8.62	10.29	12.22	14.42	16.91	19.73	
	P			2.79	2.8	2.82	2.83	2.83	2.84	2.84	2.84	2.84
Q	35°C	5.09	6.22	7.53	9.04	10.79	12.8	15.08	17.68	20.6		
P			2.52	2.53	2.54	2.55	2.56	2.57	2.57	2.58	2.58	
Q	30°C	5.36	6.53	7.89	9.47	11.29	13.37	15.74	18.43	21.46		
P			2.28	2.28	2.29	2.3	2.31	2.32	2.33	2.33	2.34	
Q	25°C	5.63	6.84	8.25	9.89	11.77	13.93	16.39	19.17	22.3		
P			2.05	2.05	2.06	2.07	2.08	2.09	2.1	2.11	2.12	
WR72KE-TFD-NNX	Q	65°C							12.82	15.16	17.83	
	P							5.55	5.55	5.55	5.55	
	Q	60°C						11.55	13.71	16.18	18.99	
	P							5.03	5.04	5.05	5.04	
	Q	55°C						10.33	12.31	14.58	17.17	20.12
	P							4.56	4.57	4.58	4.58	4.58
	Q	50°C					9.15	10.96	13.04	15.43	18.14	21.22
	P						4.12	4.14	4.15	4.16	4.16	4.16
	Q	45°C			8.04	9.68	11.58	13.76	16.25	19.09	22.3	
	P				3.72	3.74	3.75	3.76	3.77	3.78	3.77	3.77
	Q	40°C		6.99	8.48	10.2	12.18	14.46	17.06	20.02	23.36	
	P			3.36	3.38	3.39	3.4	3.41	3.42	3.42	3.42	3.42
Q	35°C	6.03	7.36	8.91	10.71	12.78	15.15	17.86	20.93	24.39		
P			3.03	3.04	3.06	3.07	3.08	3.09	3.1	3.1	3.11	
Q	30°C	6.34	7.73	9.34	11.21	13.36	15.83	18.64	21.82	25.4		
P			2.74	2.75	2.76	2.77	2.78	2.79	2.8	2.81	2.82	
Q	25°C	6.66	8.1	9.77	11.7	13.93	16.49	19.4	22.69	26.4		
P			2.47	2.47	2.48	2.49	2.51	2.52	2.53	2.54	2.55	
WR81KE-TFD-NNX	Q	65°C							13.87	16.4	19.29	
	P							6	6	6	6	
	Q	60°C						12.5	14.84	17.51	20.55	
	P							5.44	5.45	5.45	5.45	
	Q	55°C						11.18	13.32	15.78	18.58	21.77
	P							4.93	4.94	4.95	4.95	4.95
	Q	50°C					9.9	11.86	14.11	16.69	19.63	22.96
	P						4.46	4.47	4.49	4.49	4.5	4.49
	Q	45°C			8.7	10.48	12.53	14.89	17.59	20.66	24.13	
	P				4.03	4.04	4.06	4.07	4.08	4.08	4.08	4.08
	Q	40°C		7.57	9.17	11.04	13.18	15.65	18.46	21.66	25.27	
	P			3.63	3.65	3.66	3.68	3.69	3.7	3.7	3.7	3.7
Q	35°C	6.52	7.97	9.64	11.59	13.82	16.39	19.32	22.64	26.39		
P			3.28	3.29	3.3	3.32	3.33	3.34	3.35	3.35	3.36	
Q	30°C	6.86	8.36	10.11	12.13	14.46	17.12	20.16	23.61	27.49		
P			2.96	2.97	2.98	2.99	3.01	3.02	3.03	3.04	3.05	
Q	25°C	7.21	8.76	10.57	12.66	15.08	17.84	20.99	24.56	28.57		
P			2.67	2.67	2.68	2.7	2.71	2.72	2.74	2.75	2.76	

注：以上数据基于 11.1K 吸气过热度，8.3K 过冷度  
Note: The above data are based on 11.1k supheating and 8.3k subcooling.

型号Model	项目Item (kW)	Tc\Te	-25°C	-20°C	-15°C	-10°C	-5°C	0°C	5°C	10°C	15°C
WR94KE-TFD-NNX	Q	65°C							16.72	19.77	23.26
	P								7.25	7.25	7.25
	Q	60°C						15.07	17.88	21.1	24.77
	P						6.57	6.59	6.59	6.59	
	Q	55°C					13.47	16.06	19.02	22.4	26.24
	P						5.95	5.97	5.98	5.99	5.98
	Q	50°C				11.94	14.3	17.01	20.12	23.67	27.68
	P					5.39	5.41	5.42	5.43	5.43	5.43
	Q	45°C			10.48	12.63	15.1	17.95	21.2	24.9	29.09
	P				4.87	4.89	4.9	4.92	4.93	4.93	4.93
	Q	40°C		9.12	11.06	13.3	15.89	18.87	22.26	26.11	30.47
	P			4.39	4.41	4.43	4.44	4.46	4.47	4.47	4.47
	Q	35°C	7.86	9.6	11.62	13.97	16.67	19.76	23.29	27.3	31.82
	P			3.96	3.98	3.99	4.01	4.02	4.04	4.05	4.05
	Q	30°C	8.27	10.08	12.18	14.62	17.43	20.64	24.31	28.46	33.14
	P			3.58	3.59	3.6	3.62	3.63	3.65	3.66	3.67
Q	25°C	8.69	10.56	12.74	15.27	18.18	21.51	25.31	29.6	34.44	
P			3.22	3.23	3.24	3.26	3.27	3.29	3.31	3.32	3.33
WR108KE-TFD-NNX	Q	65°C							18.6	22	25.88
	P								8.03	8.04	8.04
	Q	60°C						16.77	19.9	23.48	27.56
	P							7.28	7.3	7.3	7.3
	Q	55°C					14.99	17.86	21.16	24.92	29.2
	P						6.6	6.62	6.63	6.63	6.63
	Q	50°C				13.28	15.91	18.93	22.39	26.33	30.8
	P					5.97	5.99	6.01	6.02	6.02	6.02
	Q	45°C			11.67	14.05	16.8	19.97	23.59	27.71	32.37
	P				5.39	5.42	5.44	5.45	5.46	5.47	5.46
	Q	40°C		10.15	12.3	14.8	17.68	20.99	24.77	29.05	33.9
	P			4.87	4.89	4.91	4.93	4.94	4.95	4.96	4.96
	Q	35°C	8.75	10.68	12.93	15.54	18.54	21.99	25.92	30.37	35.4
	P			4.39	4.41	4.42	4.44	4.46	4.47	4.49	4.49
	Q	30°C	9.21	11.22	13.56	16.27	19.39	22.97	27.05	31.67	36.87
	P			3.97	3.98	4	4.01	4.03	4.04	4.06	4.07
Q	25°C	9.67	11.75	14.18	16.99	20.22	23.93	28.16	32.94	38.32	
P			3.57	3.58	3.6	3.61	3.63	3.65	3.66	3.68	3.7
WR125KE-TFD-NNX	Q	65°C							21.67	25.63	30.14
	P								9.45	9.46	9.45
	Q	60°C						19.53	23.18	27.35	32.1
	P							8.57	8.59	8.59	8.59
	Q	55°C					17.46	20.81	24.65	29.04	34.02
	P						7.76	7.78	7.8	7.8	7.8
	Q	50°C				15.48	18.53	22.05	26.08	30.68	35.88
	P					7.02	7.05	7.07	7.08	7.08	7.08
	Q	45°C			13.59	16.37	19.58	23.26	27.48	32.28	37.7
	P				6.34	6.37	6.39	6.41	6.42	6.43	6.43
	Q	40°C		11.82	14.33	17.24	20.6	24.45	28.85	33.85	39.49
	P			5.73	5.75	5.77	5.79	5.81	5.82	5.83	5.83
	Q	35°C	10.19	12.45	15.07	18.1	21.6	25.61	30.19	35.38	41.24
	P			5.16	5.18	5.2	5.23	5.24	5.26	5.28	5.29
	Q	30°C	10.72	13.07	15.79	18.95	22.59	26.76	31.51	36.89	42.95
	P			4.67	4.68	4.7	4.72	4.74	4.76	4.77	4.79
Q	25°C	11.26	13.69	16.51	19.79	23.56	27.88	32.8	38.37	44.64	
P			4.2	4.21	4.23	4.25	4.27	4.29	4.31	4.33	4.35

注：以上数据基于 11.1K 吸气过热度，8.3K 过冷度  
Note: The above data are based on 11.1k supheating and 8.3k subcooling.

型号Model	项目Item (kW)	Tc\Te	-25°C	-20°C	-15°C	-10°C	-5°C	0°C	5°C	10°C	15°C	
WR144KE-TFD-NNX	Q	65°C							24.99	29.55	34.76	
	P								10.48	10.5	10.49	
	Q	60°C						22.53	26.73	31.55	37.02	
	P							9.51	9.53	9.54	9.53	
	Q	55°C					20.14	24	28.43	33.49	39.23	
	P						8.61	8.64	8.66	8.66	8.66	
	Q	50°C				17.85	21.37	25.43	30.08	35.38	41.38	
	P					7.79	7.82	7.84	7.86	7.86	7.86	
	Q	45°C			15.67	18.88	22.58	26.83	31.69	37.23	43.48	
	P				7.04	7.07	7.1	7.12	7.13	7.14	7.13	
	Q	40°C		13.63	16.53	19.89	23.76	28.2	33.27	39.03	45.54	
	P			6.35	6.38	6.41	6.43	6.45	6.46	6.47	6.47	
	Q	35°C	11.75	14.35	17.38	20.88	24.91	29.54	34.82	40.81	47.56	
	P			5.73	5.75	5.78	5.8	5.82	5.84	5.86	5.87	5.87
	Q	30°C	12.37	15.07	18.21	21.85	26.05	30.86	36.34	42.54	49.54	
	P			5.18	5.2	5.22	5.24	5.26	5.28	5.3	5.31	5.33
Q	25°C	12.99	15.79	19.04	22.82	27.17	32.15	37.83	44.25	51.48		
P			4.66	4.68	4.69	4.72	4.74	4.76	4.78	4.81	4.83	
WR160KE-TFD-NNX	Q	65°C							27.38	32.38	38.09	
	P								11.35	11.36	11.36	
	Q	60°C						24.68	29.29	34.56	40.56	
	P							10.3	10.32	10.32	10.32	
	Q	55°C						22.06	26.29	31.15	36.69	42.98
	P							9.33	9.35	9.37	9.38	9.37
	Q	50°C					19.55	23.42	27.86	32.96	38.76	45.34
	P						8.44	8.47	8.49	8.51	8.51	8.51
	Q	45°C				17.17	20.68	24.74	29.4	34.72	40.78	47.64
	P					7.62	7.65	7.68	7.7	7.72	7.72	7.72
	Q	40°C		14.94	18.11	21.79	26.03	30.89	36.45	42.77	49.89	
	P			6.88	6.91	6.94	6.96	6.98	7	7.01	7.01	
	Q	35°C	12.88	15.73	19.04	22.87	27.29	32.36	38.15	44.71	52.1	
	P			6.2	6.23	6.25	6.28	6.3	6.32	6.34	6.35	6.36
	Q	30°C	13.55	16.51	19.95	23.94	28.54	33.81	39.81	46.61	54.27	
	P			5.61	5.62	5.65	5.67	5.69	5.71	5.73	5.75	5.76
Q	25°C	14.23	17.3	20.86	25	29.77	35.23	41.44	48.48	56.4		
P			5.05	5.06	5.08	5.1	5.13	5.15	5.18	5.2	5.22	
WR190KE-TFD-NNX	Q	65°C							32.64	38.6	45.41	
	P								13.69	13.7	13.7	
	Q	60°C						29.43	34.92	41.2	48.36	
	P							12.42	12.44	12.45	12.44	
	Q	55°C						26.31	31.35	37.13	43.74	51.24
	P							11.25	11.28	11.3	11.31	11.3
	Q	50°C					23.31	27.92	33.22	39.29	46.21	54.05
	P						10.17	10.21	10.24	10.26	10.27	10.26
	Q	45°C				20.47	24.66	29.49	35.05	41.4	48.62	56.8
	P					9.19	9.23	9.27	9.29	9.31	9.32	9.31
	Q	40°C			17.81	21.59	25.97	31.03	36.83	43.46	50.99	59.49
	P				8.3	8.33	8.37	8.4	8.42	8.44	8.45	8.45
	Q	35°C	15.35	18.75	22.7	27.27	32.54	38.58	45.48	53.3	62.12	
	P			7.48	7.51	7.54	7.57	7.6	7.62	7.65	7.66	7.67
	Q	30°C	16.16	19.69	23.79	28.54	34.02	40.3	47.46	55.57	64.7	
	P			6.76	6.78	6.81	6.84	6.87	6.89	6.92	6.94	6.95
Q	25°C	16.97	20.62	24.88	29.81	35.49	42	49.41	57.8	67.24		
P			6.09	6.11	6.13	6.16	6.19	6.22	6.25	6.27	6.3	

注：以上数据基于 11.1K 吸气过热度，8.3K 过冷度  
Note: The above data are based on 11.1k supheating and 8.3k subcooling.

型号Model	项目Item (kW)	Tc\Te	-25°C	-20°C	-15°C	-10°C	-5°C	0°C	5°C	10°C	15°C
WR250KE-TWD-GNX	Q	65°C							42.62	50.41	59.29
	P								17.87	17.89	17.88
	Q	60°C						38.42	45.59	53.8	63.15
	P							16.21	16.25	16.26	16.25
	Q	55°C					34.35	40.93	48.49	57.11	66.91
	P					14.69	14.73	14.76	14.77	14.76	14.76
	Q	50°C				30.44	36.45	43.38	51.3	60.34	70.58
	P				13.28	13.33	13.37	13.4	13.41	13.4	13.4
	Q	45°C			26.73	32.2	38.51	45.76	54.06	63.49	74.16
	P				12	12.05	12.1	12.13	12.16	12.16	12.16
	Q	40°C		23.25	28.19	33.92	40.52	48.09	56.75	66.57	77.67
	P			10.83	10.88	10.93	10.96	11	11.02	11.03	11.04
	Q	35°C	20.04	24.48	29.64	35.61	42.49	50.38	59.38	69.59	81.11
	P		9.77	9.81	9.85	9.89	9.92	9.96	9.98	10	10.01
	Q	30°C	21.1	25.7	31.06	37.27	44.43	52.63	61.97	72.56	84.48
	P		8.83	8.86	8.89	8.93	8.96	9	9.03	9.06	9.08
	Q	25°C	22.15	26.92	32.48	38.92	46.34	54.84	64.52	75.47	87.8
	P		7.95	7.97	8	8.04	8.08	8.12	8.16	8.19	8.23
WR310KE-TWD-GNX	Q	65°C							52.46	62.04	72.97
	P								22	22.02	22.01
	Q	60°C						47.29	56.12	66.22	77.72
	P							19.95	20	20.01	20
	Q	55°C					42.28	50.38	59.67	70.29	82.35
	P					18.07	18.13	18.16	18.17	18.16	18.16
	Q	50°C				37.46	44.87	53.38	63.14	74.26	86.86
	P					16.35	16.41	16.46	16.49	16.5	16.49
	Q	45°C			32.9	39.63	47.39	56.32	66.53	78.14	91.28
	P				14.77	14.84	14.89	14.93	14.96	14.97	14.97
	Q	40°C		28.62	34.7	41.74	49.87	59.19	69.84	81.94	95.6
	P			13.33	13.39	13.45	13.49	13.53	13.56	13.58	13.58
	Q	35°C	24.67	30.13	36.48	43.82	52.29	62.01	73.09	85.66	99.83
	P		12.02	12.07	12.12	12.17	12.21	12.25	12.29	12.31	12.32
	Q	30°C	25.96	31.64	38.23	45.87	54.68	64.77	76.27	89.3	103.98
	P		10.86	10.9	10.94	10.99	11.03	11.08	11.12	11.15	11.17
	Q	25°C	27.27	33.14	39.98	47.9	57.03	67.5	79.41	92.89	108.06
	P		9.78	9.81	9.85	9.89	9.94	9.99	10.04	10.08	10.12

注：以上数据基于 11.1K 吸气过热度，8.3K 过冷度  
 Note: The above data are based on 11.1k supheating and 8.3k subcooling.



为山® 涡旋压缩机

WEISHANS SCROLL COMPRESSOR

# 2HP-25HP

致力于为客户提供绿色环保的空调，冷水机，热泵及冷冻冷藏解决方案  
 We are committed to providing our customers with environmentally friendly air conditioning, chillers, heat pumps, and refrigeration solutions



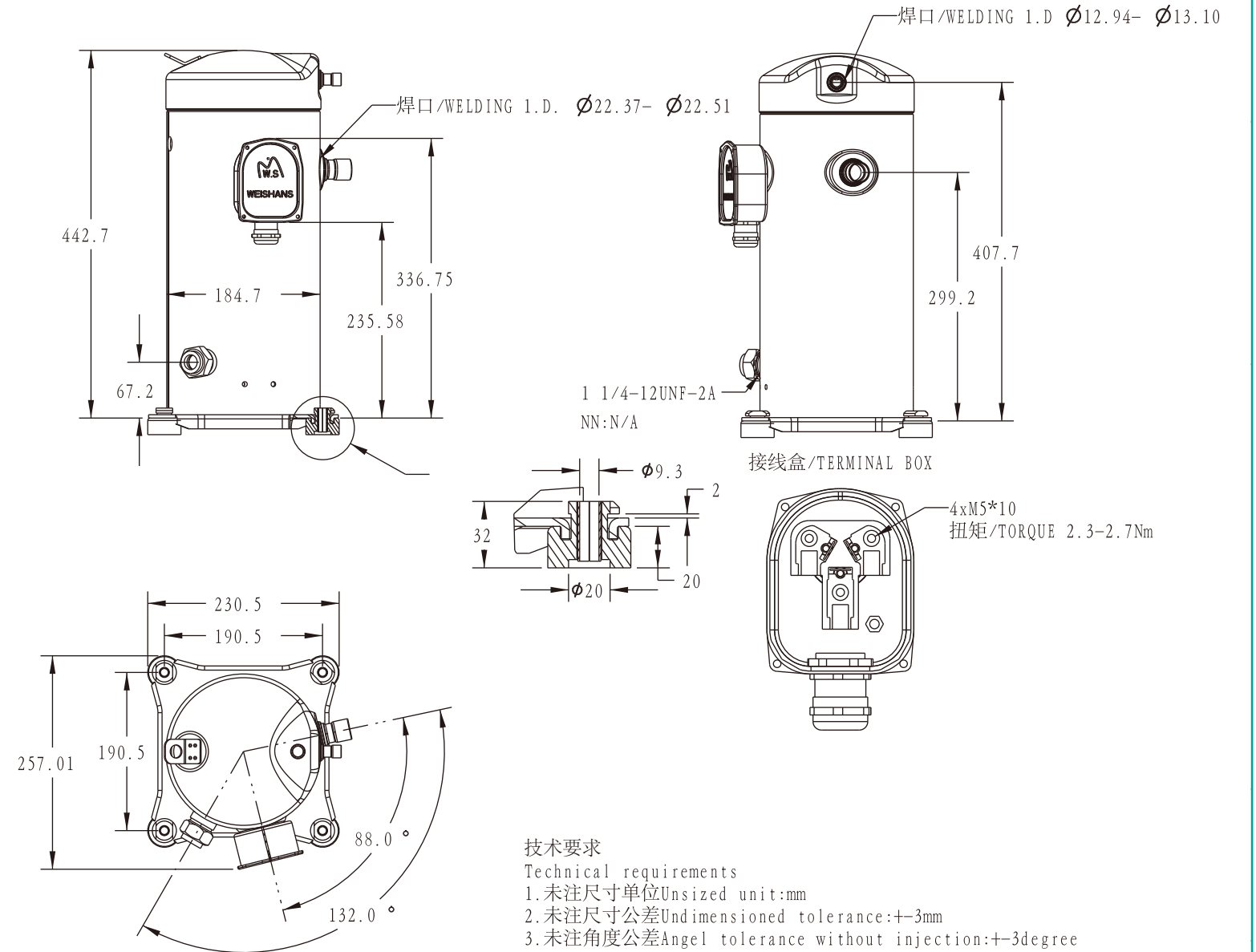
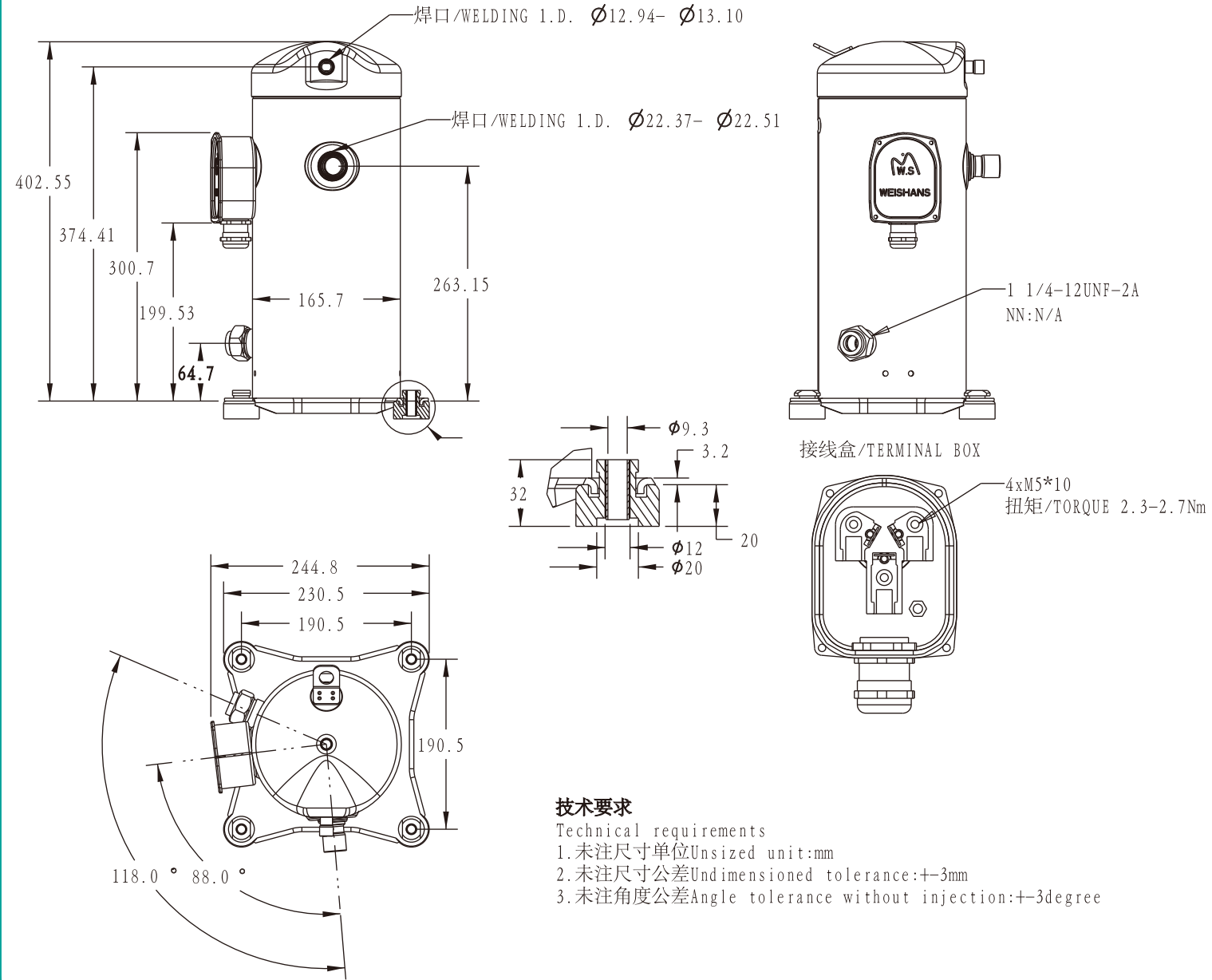

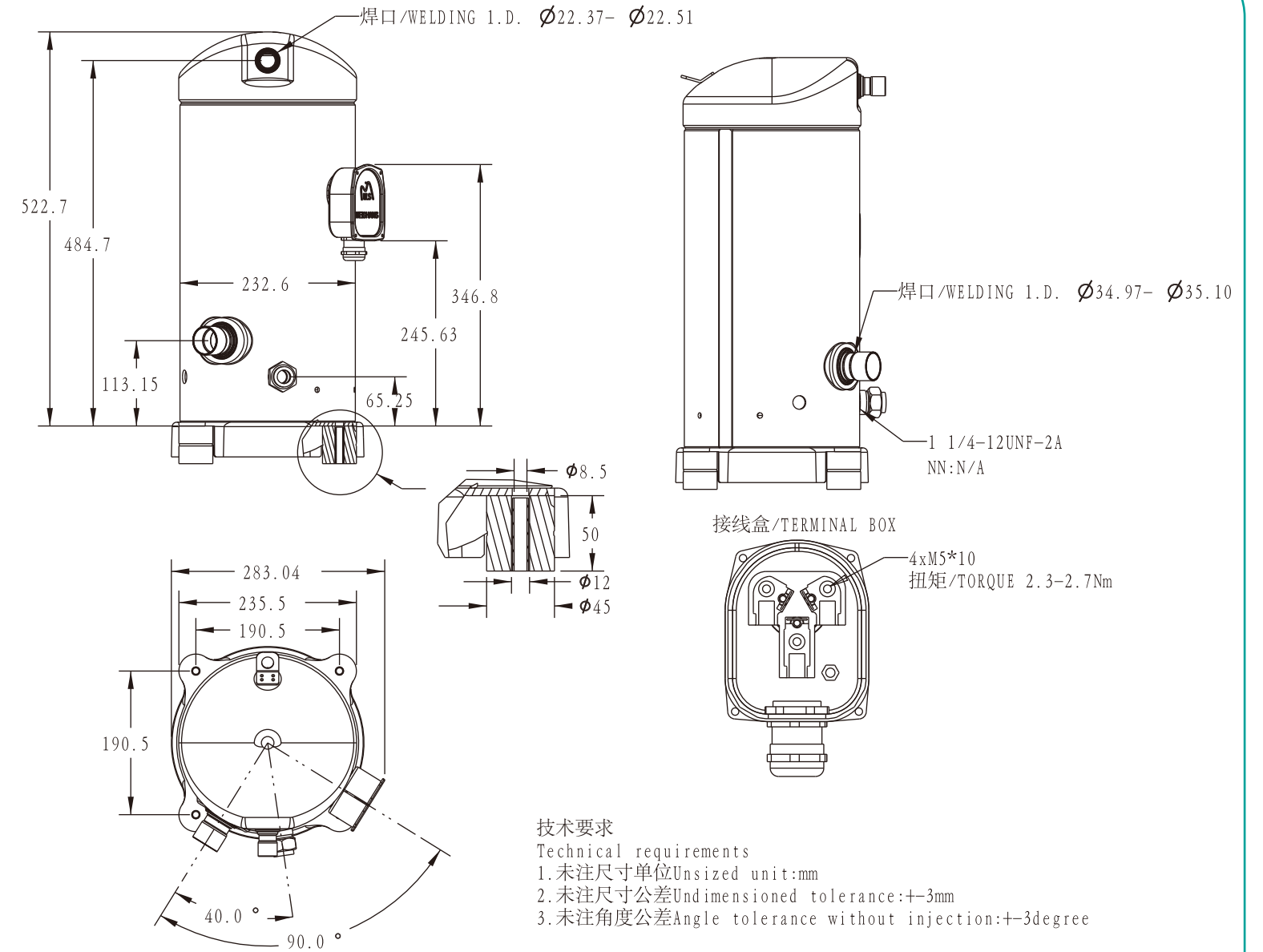
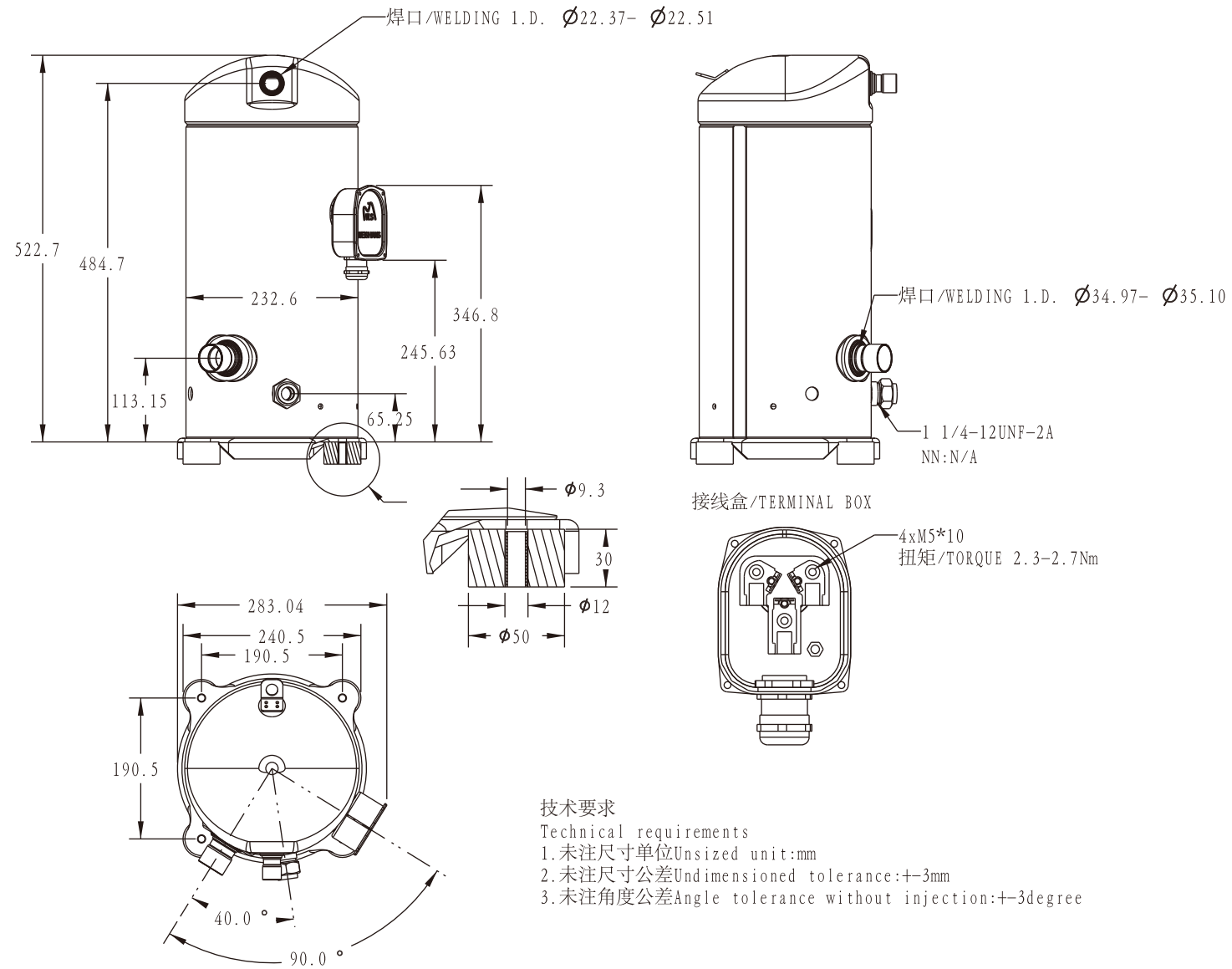

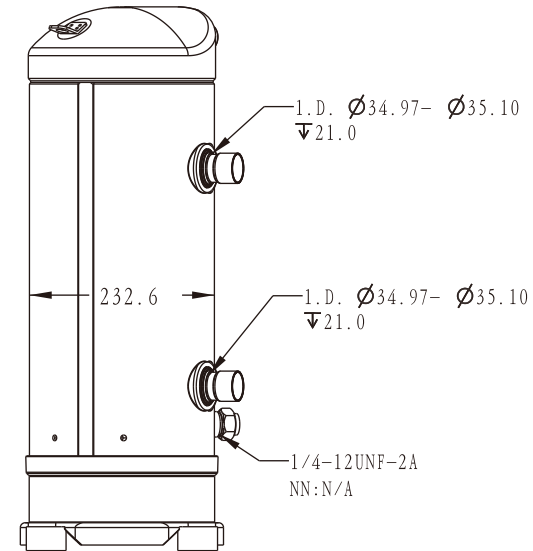
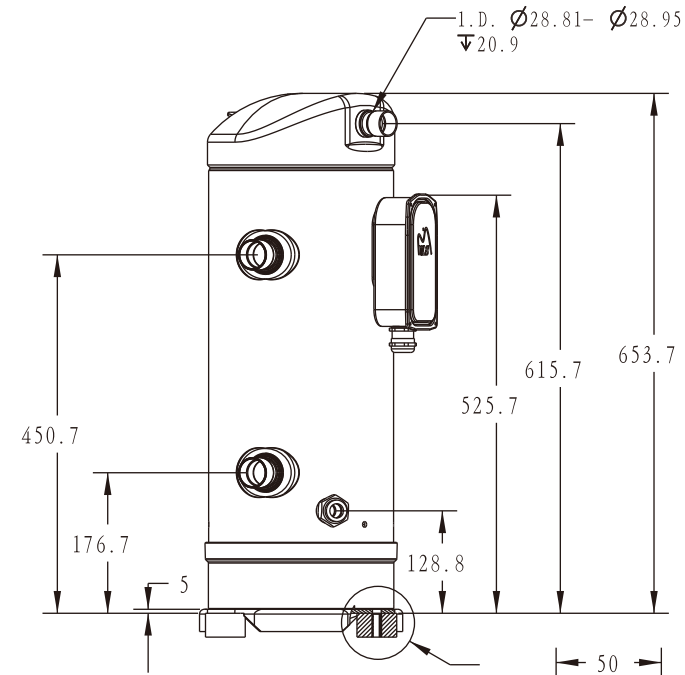

接线方式/WIRING METHOD

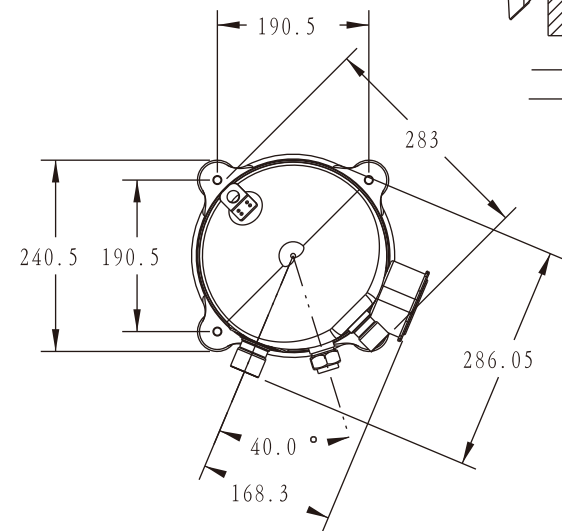
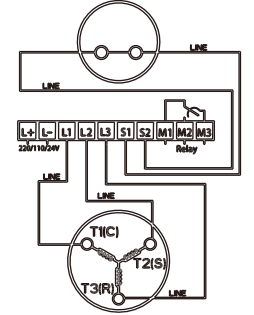

### 技术要求

Technical requirements

1. 未注尺寸单位: mm

2. 未注尺寸公差:  $\pm 3\text{mm}$

3. 未注角度公差: Angle tolerance without injection:  $\pm 3\text{degree}$

